

SL2700

LIFT & SLIDE THERMAL
INSULATING SYSTEM
FOR HIGH-END
STRUCTURES

WE ARE
A PART OF
TOMORROW!



WE ARE
A PART OF
TOMORROW!



The Stunning New Cabrits Resort
& Spa Kempinski Dominica is a
totally ALUMINCO experience!

With compliments!

THE LIFT-AND-SLIDE SL2700 REPRESENTS THE NEW GENERATION OF HIGH-END SYSTEMS.

Now, in the ALUMINCO portfolio, there is even more design, even more heavy-duty performance, even more possibilities for virtually any location in the world.

DISCOVER THE NEW ALUMINCO SL2700!
THE BEGINNING OF A GREAT PASSION!

ULTIMATE HIGH-END LOOK GRANTS FREEDOM



Attractive and effective slim-frame-lines, excellent thermal insulation values and high-quality components create an exceptionally uplifting atmosphere.

The architectural aesthetics are depicted on the narrow interlocking face width which permits greater visibility and flow of light, while the ground level threshold offers high comfort and ease of access.

- > Clean flat lines create a new level of aesthetics.
- > Narrow interlocking section with face widths from 43 mm for max transparency.
- > The use of a ground-level, flat threshold of only 25 mm provide the highest level of comfort.

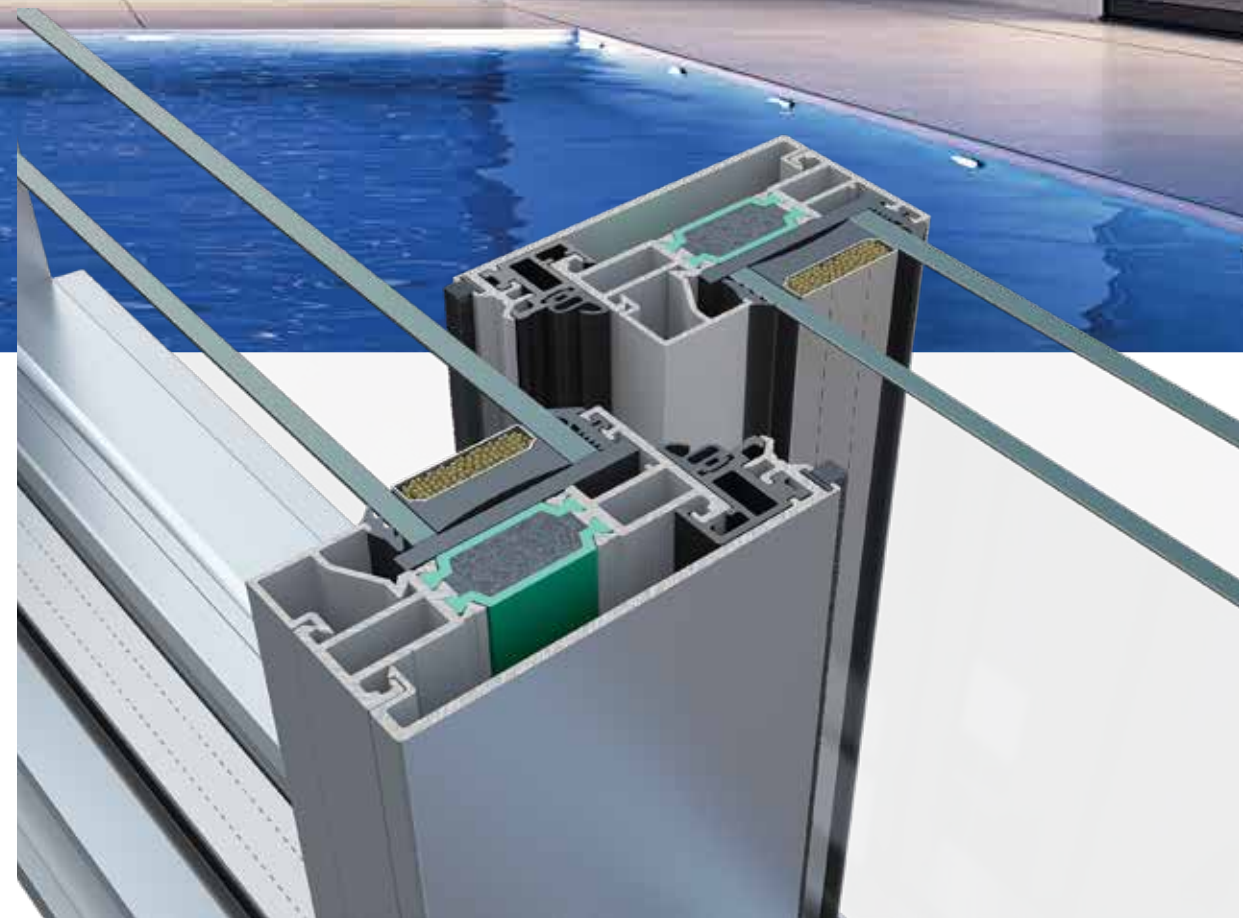

HEAVY-DUTY PERFORMANCE FOR VIRTUALLY ALL ENVIRONMENTS

The ALUMINCO SL2700 is designed from scratch and, as a result, is our most thermally efficient lift-and-side system.

Applying the most accurate performance testing for air, water, wind, sound insulation, structural and forced entry, this next generation system is capable to meet the most extreme performance requirements making it suitable for virtually any location in the world.

- > high rating in thermal insulation index, U_f from $1.7 \text{ W/m}^2\text{K}$
- > with an overall sash depth of 70 mm, exceptional protection from exterior elements is provided while a comfortable and quiet indoor experience is delivered.
- > benefit from high wind load and air-and-water infiltration performance, suitable for high rise applications.

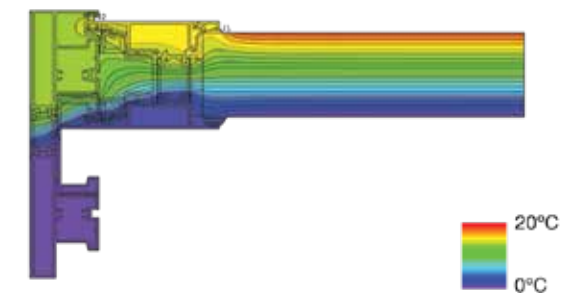

Rate of Insulation

$U_w = 1.55 \text{ W/m}^2\text{K}$

Thermal conductivity coefficient has calculated for the construction: **4000x2400 with $U_g = 1.0 \text{ W/m}^2\text{K}$**
Glass type: 5/24 (ARGON) /6

EXCEEDING CONVENTIONAL APPLICATIONS

FULFILLING THE NEED FOR WIDE SPANS

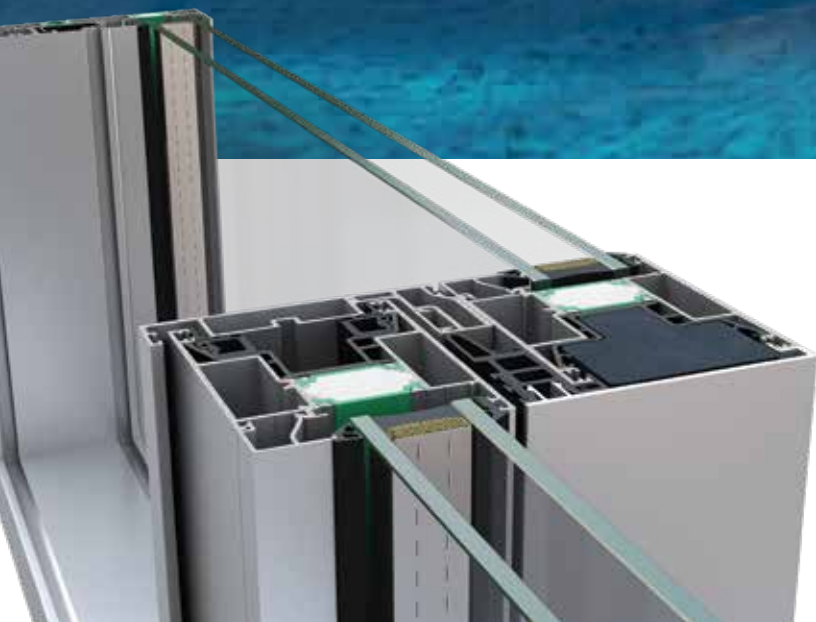

The SL2700 is highly durable and is designed to provide more opportunities and more options to the modern professional, therefore upgraded in one of the most efficient systems in its category!

From new construction to remodeling projects, the demand for multi configurations and large units with maximum light penetration is what the ALUMINCO SL2700 has been engineered for.

- > sash units of up to 3 x 3 meters
- > minimal frame with narrow interlock is even possible at a meeting style connection.
- > high quality fitting components for open and close with ease
- > highly secure multipoint lock with anti-lifter

THE HOTEL SOLUTION EXCLUSIVE PACKAGE

As a system-built architectural solution, the hotel edition can accommodate all known configurations, underscoring the multilayer character of the system.

Thanks to the unique features of the system, all design elements are functionally supported by the hotel edition types, whereas oversized constructions can be accomplished.

- > Optimum combination of comfort and efficiency.
- > Hotel type configurations are specifically engineered to meet the higher standards of hoteliers.
- > Rooms and shared spaces are flooded with light thanks to the minimal frame edition and when used in combination with the flat bottom threshold, totally easy access is experienced.
- > All-glass corners are even possible with the hotel solution frames, as an extra option for more transparency and space.



CORNERLESS AND ALL-GLASS CORNERS ARE EXCITINGLY POSSIBLE FOR BREATHTAKING VIEWS

For the most architecturally challenging projects, the system offers all-glass corners as well as 90° open corners requiring no structural post.

Whether you choose an open corner solution or an all-glass corner, a particularly bright and welcoming ambience in the interior is ensured.

- > revel in more style and modernity
- > maximum transparency and light penetration
- > create a greater sense of space

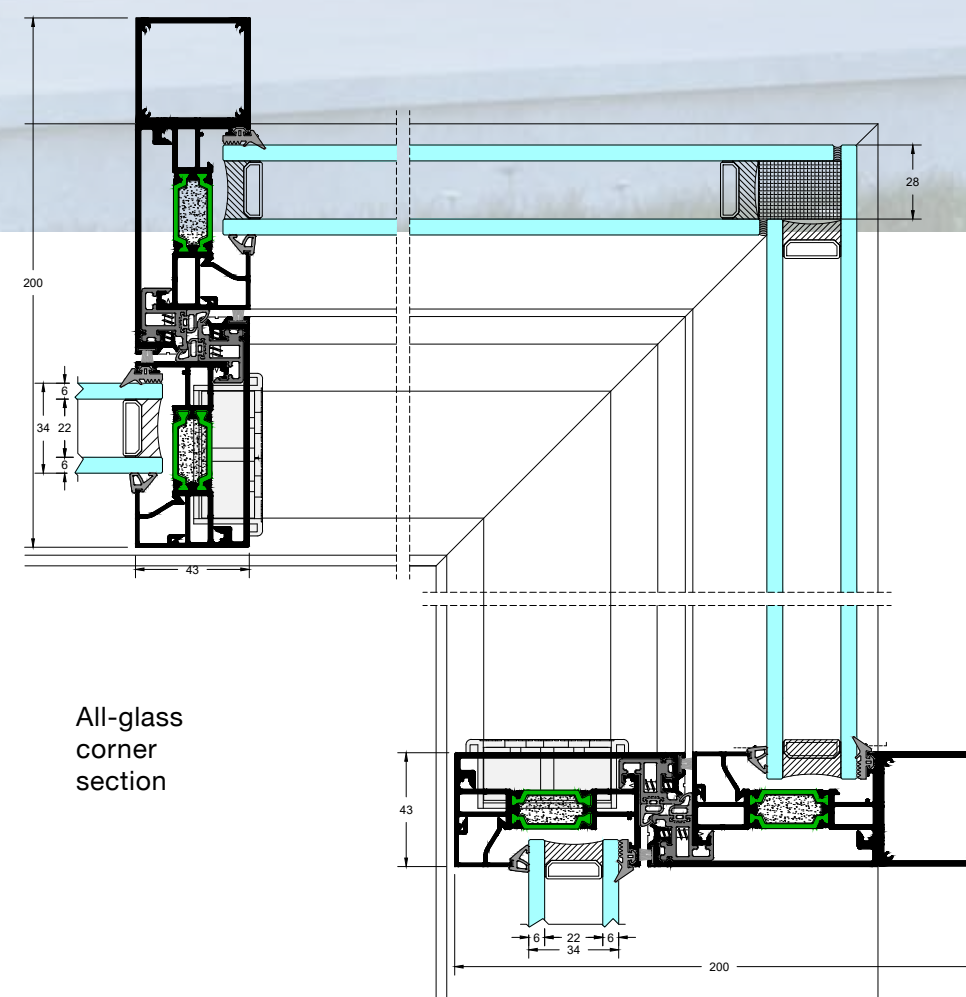

MORE FLEXIBILITY IN LOCKING.

With the new range of fittings, two different options are available. Both ways, the security components are not visible from outside, providing a uniform appearance to the system.



The locking is almost flush fitted in the outer frame, which means that technical details are not visible. This option can meet higher wind loads.



The bolt pins are fixed in the outer frame, providing a consistent and reliable connection between the sash and the frame.



FLOOR TRACK SOLUTIONS

The SL2700 offers a complete range of tracks to fulfil different requirements in advance of the design, the level of comfort and the performance degree.

Single, double, triple, raised, low bottom, flat, viewless are options where almost cover every possible configuration in the real construction. All tracks are thermally insulated for optimum energy efficiency and give the option to be installed flush at interior floor where a drainage system is required.

1 HIGH PERFORMANCE TRACK (RAISED)

The high-performance track is the most weather resistant solution and the most popular one.

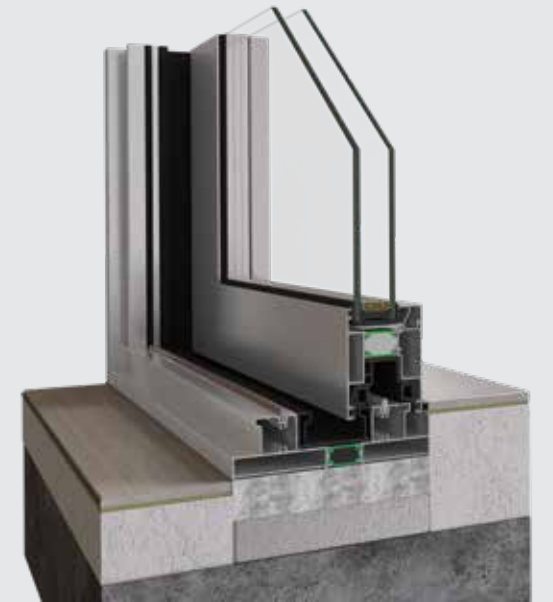

2 LOW BOTTOM TRACK

With the low bottom track, accessibility for all users is ensured. Suitable for almost all areas commercial or residential premises.

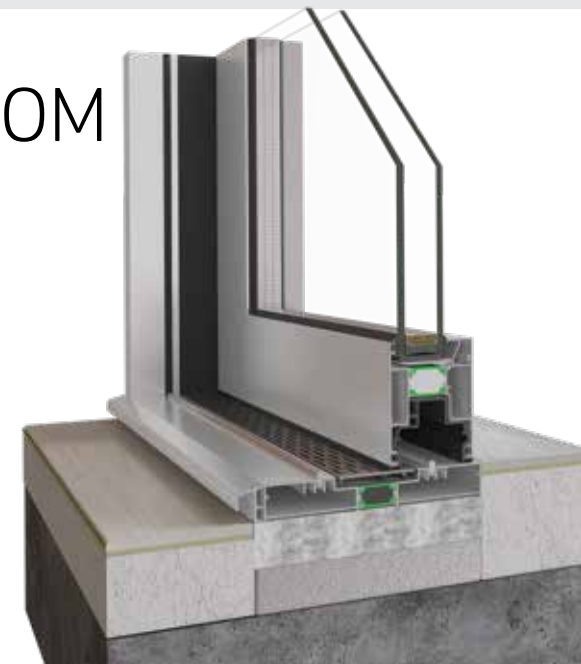

3 FLAT TRACK

The use of a flat track provides an easy access from inside to outside. Ideal for people with disabilities - ADA compliance. Furthermore, the flatness offer protection from dirt collecting in the bottom track.

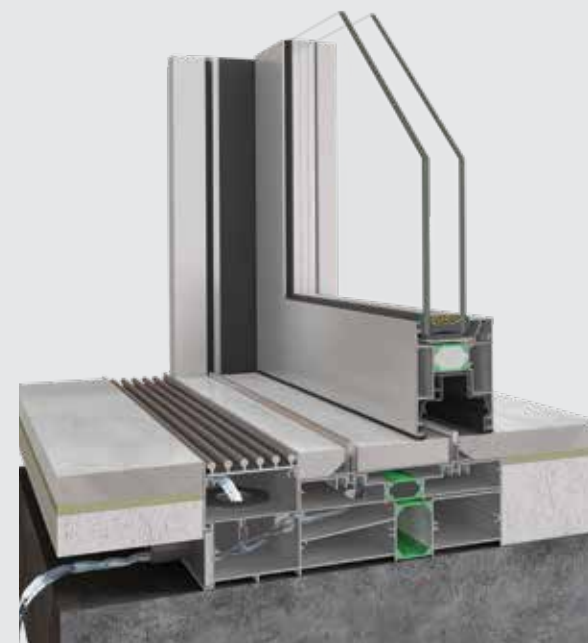

4 VIEWLESS TRACK

The «viewless» track, totally concealed into the floor and covered with the floor finish, offers the most 'visual impact' solution with outstanding user comfort-ideal for use as a high-end solution in premium commercial projects and luxury residential properties. Top-class water tightness is achieved thanks to the effectiveness of the concealed water drainage system.

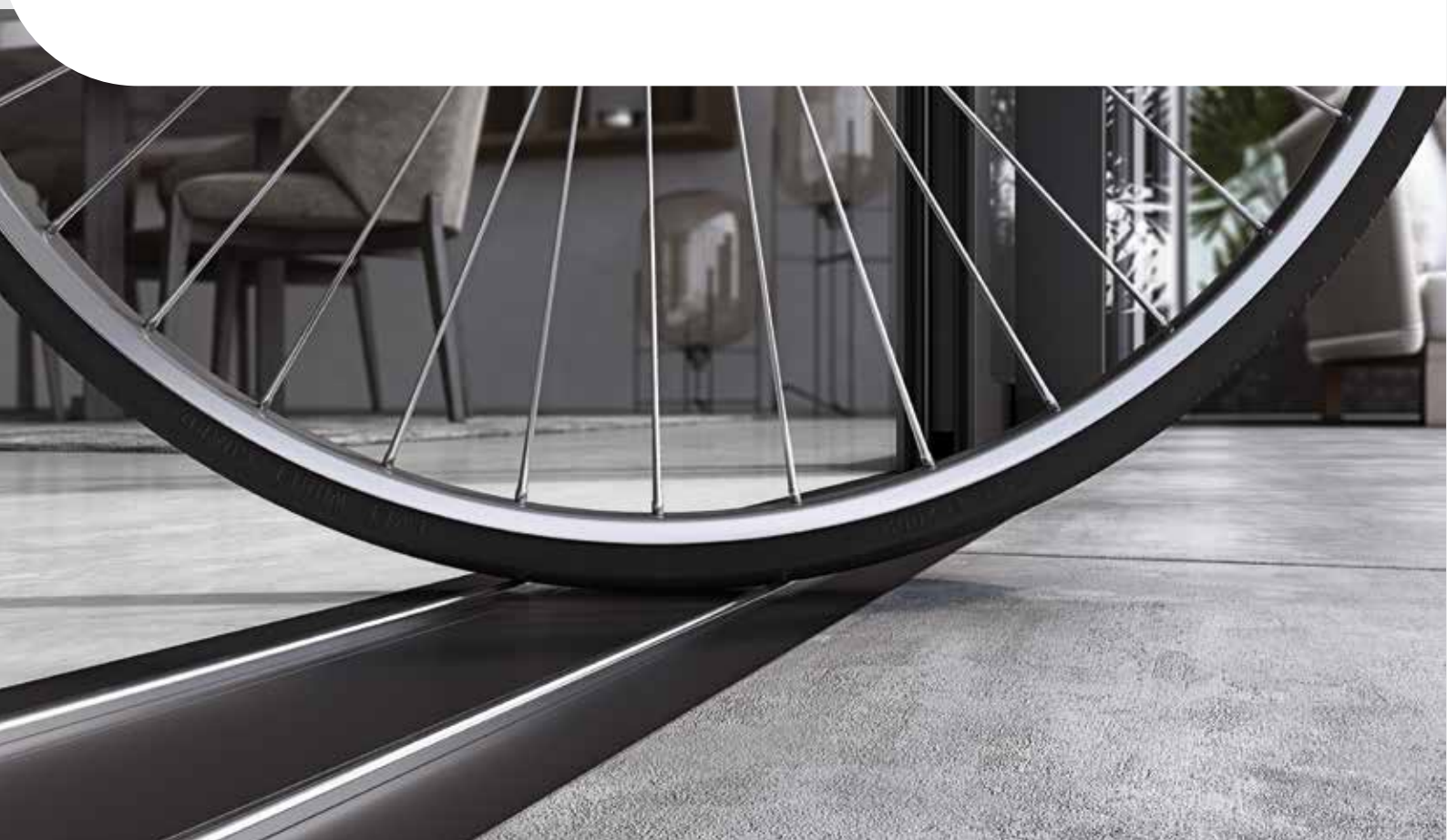

TOP-CLASS WATER TIGHTNESS IS ACHIEVED THANKS TO THE EFFECTIVENESS OF THE CONCEALED WATER DRAINAGE SYSTEM.

Every part of a top aluminium system needs to be perfectly combined in order to form a well-balanced integrated structure. And the controlled drainage of water is no exception.

A drainage system within the outer frame ensure controlled drainage of water. The excellent water tightness performance is achieved by using a specially designed profile incorporated as a trough under the system's track, allowing the water to flow through the high-quality plastic fittings straight into the drainage network.

In addition, the symmetrical holes on the profile facilitate and channel effectively the water in the rail's internal chamber, allowing its' easy and quick way out.

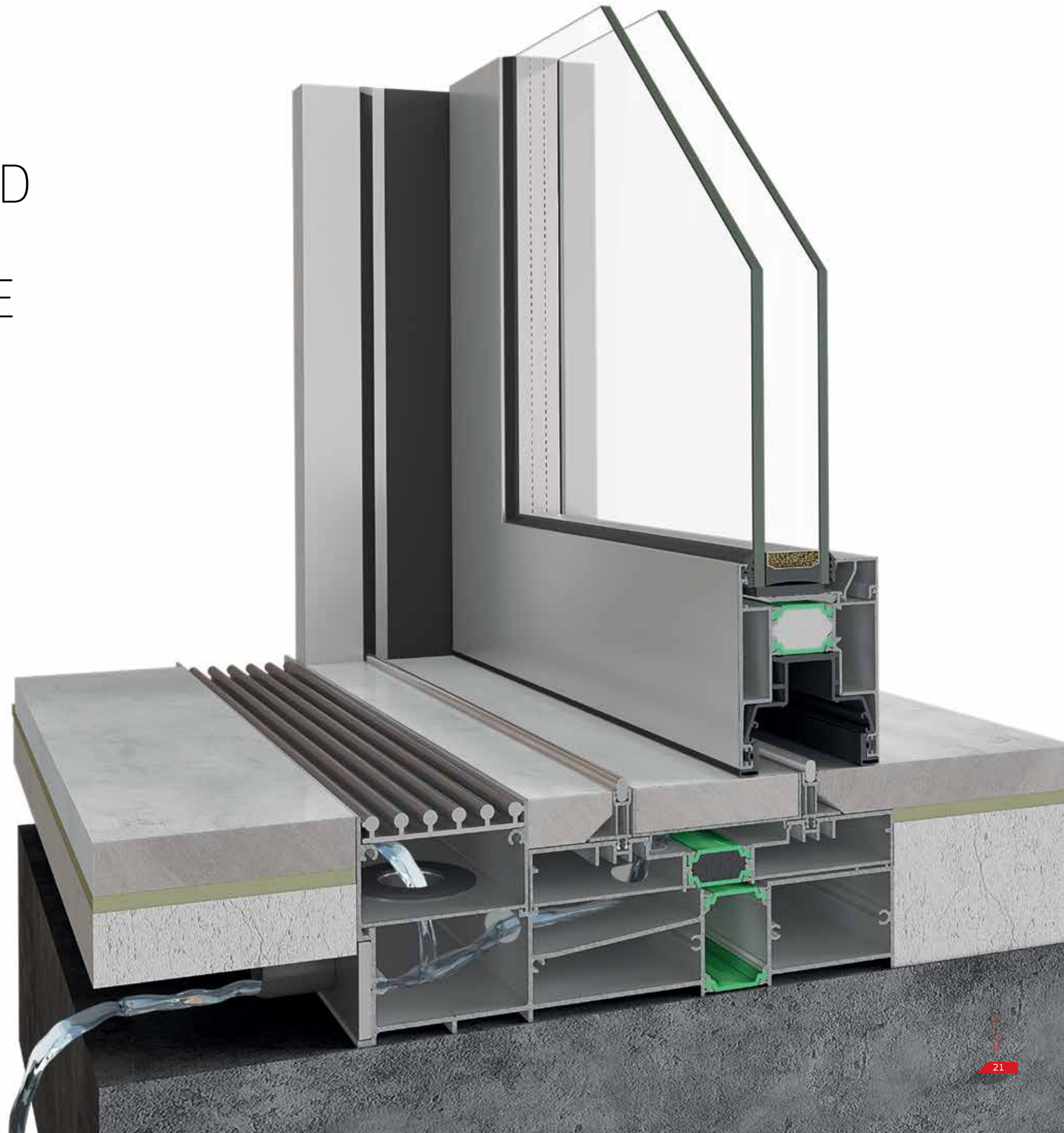

CONFIGURATIONS

High performance frame

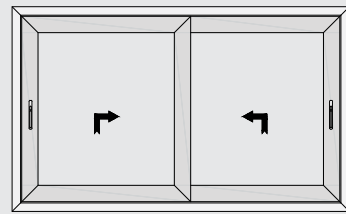

standard frame
2-sashes double track

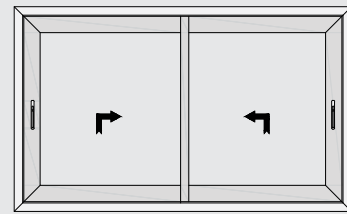

standard frame
2-sashes double track
with narrow interlock

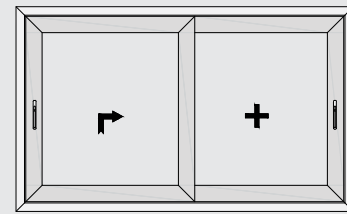

standard frame
1-sash 1-fixed

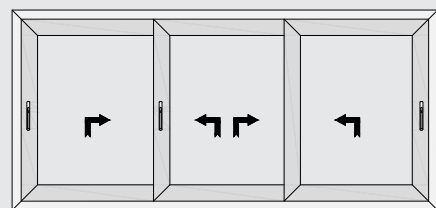

standard frame
3-sashes 1-side slide triple track

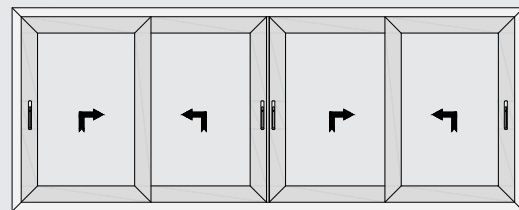

standard frame
4-sashes double track
with meeting style

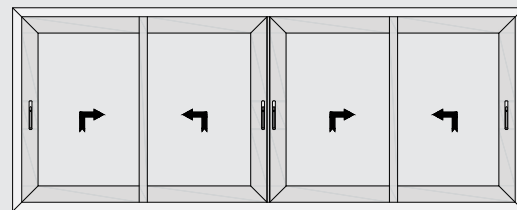

standard frame
4-sashes double track
with narrow interlock and meeting style

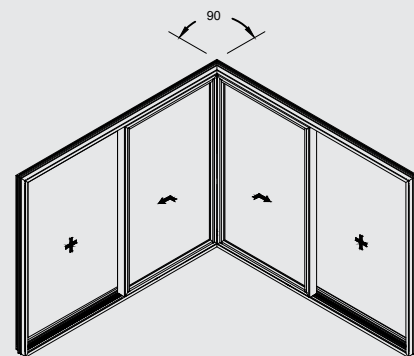

internal-external corner
fixed 2-sashes fixed

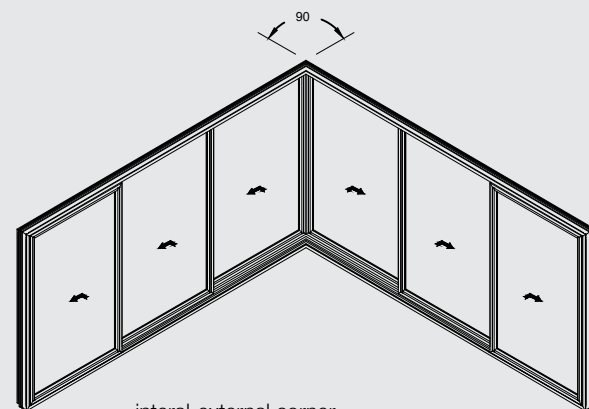

internal-external corner
3-sashes triple track

Low bottom frame / Flat frame / Embedded frame

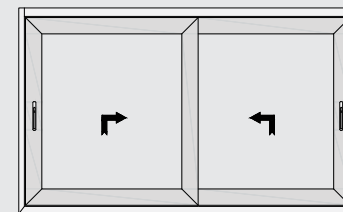

minimal frame
2-sashes double track

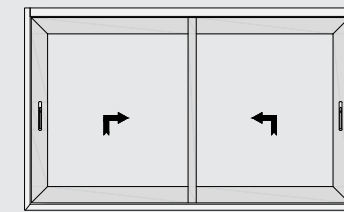

minimal frame
2-sashes double track
with narrow interlock

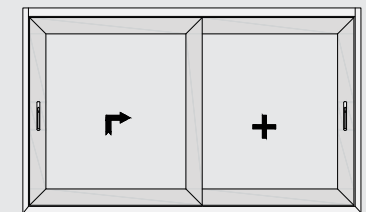

minimal frame
1-sash 1-fixed

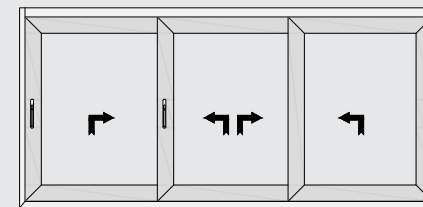

minimal frame
3-sashes 1-side slide triple track

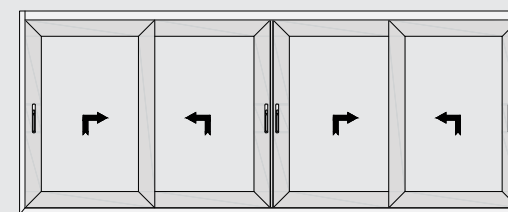

minimal frame
4-sashes double track
with meeting style minimal frame

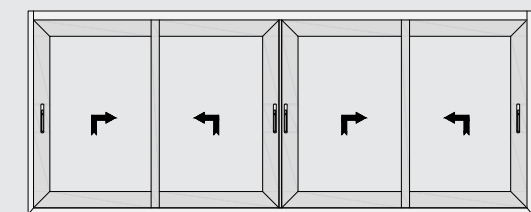

minimal frame
4-sashes double track
with narrow interlock and meeting style

Hotel solutions frame

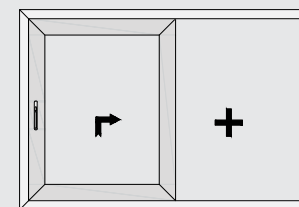

hotel solution
1-sash 1-fixed

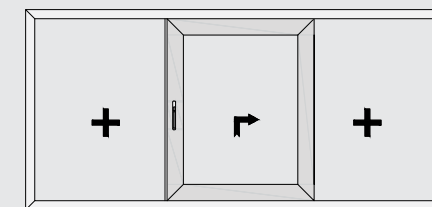

hotel solution
1-fixed 1-sash 1-fixed

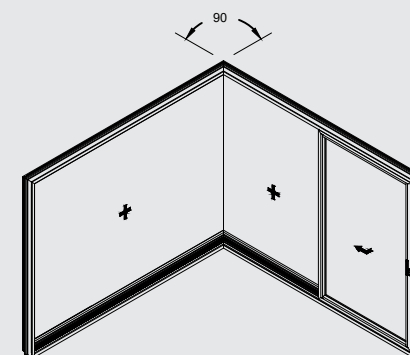

internal-external corner
2-fixed 1-sash

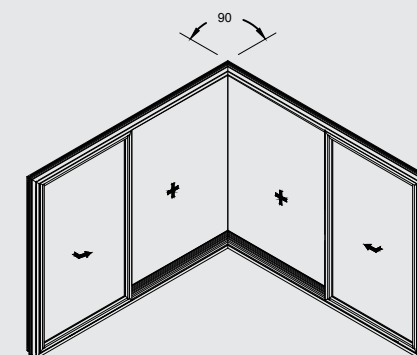

internal-external corner
1-sash 2-Fixed 1-sash

TECHNICAL CHARACTERISTICS

| Technical characteristics | |
|-------------------------------|-------------------------------|
| Hardware | Lift & slide |
| Min. face height | 116 mm |
| Frame height | 25 / 45 mm |
| Frame width | 174 mm |
| Sash height | 88 mm |
| Sash width | 70 mm |
| Interlocking profile width | 43 / 96 mm |
| Sash Weight | up to 400 Kg |
| Glass thickness | 24-52 mm |
| Insulation | Polyamides |
| Performances | |
| Thermal insulation EN 10077-2 | U _f from 1.7 W/m²K |

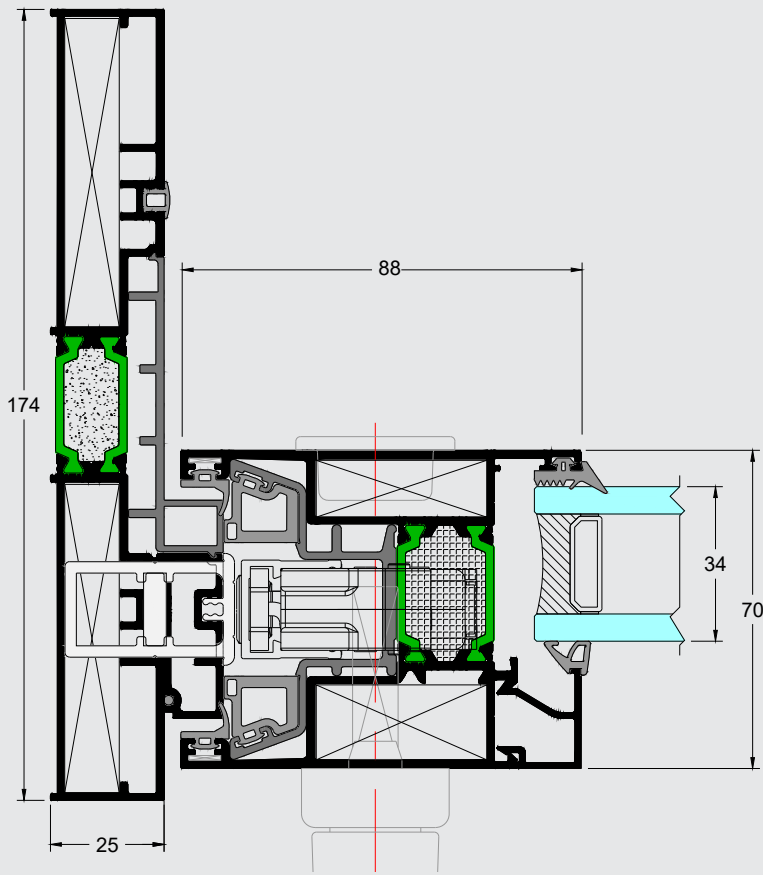

Minimal overlapping frame

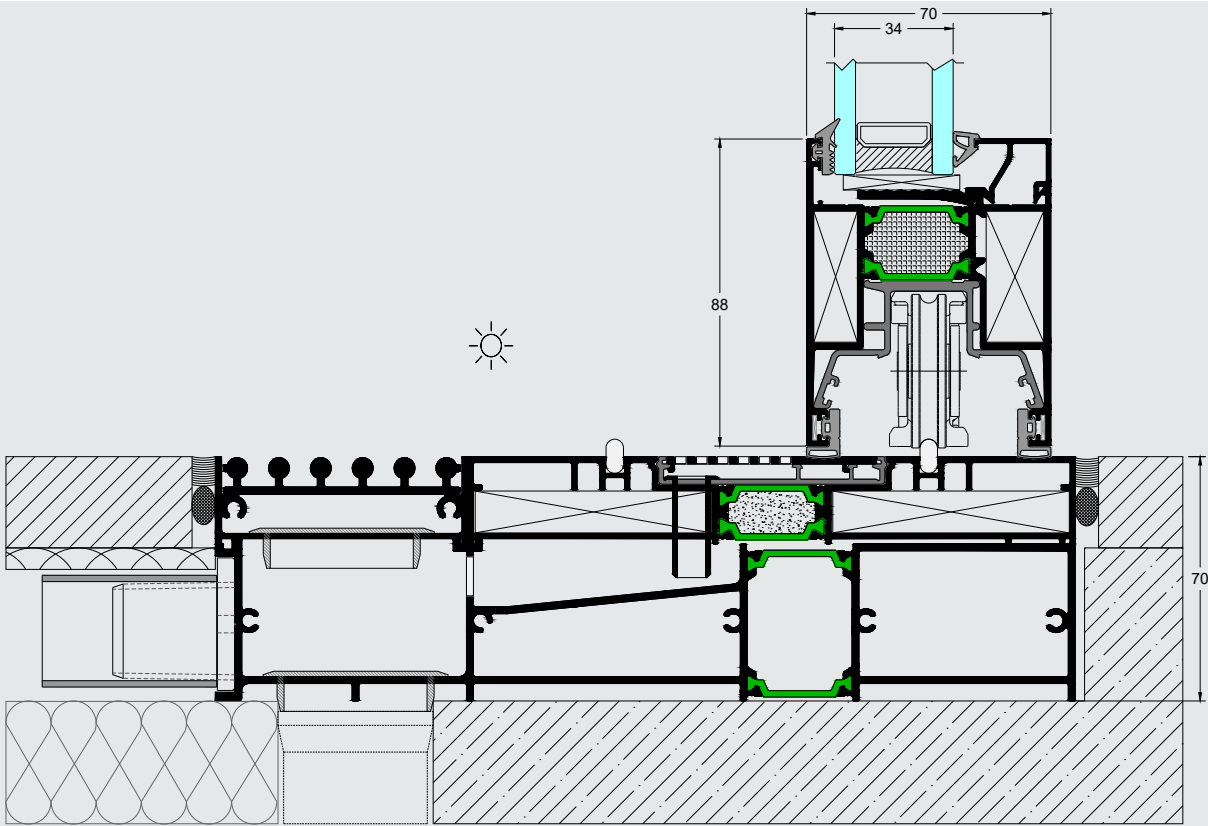

Flat bottom track - water drainage system

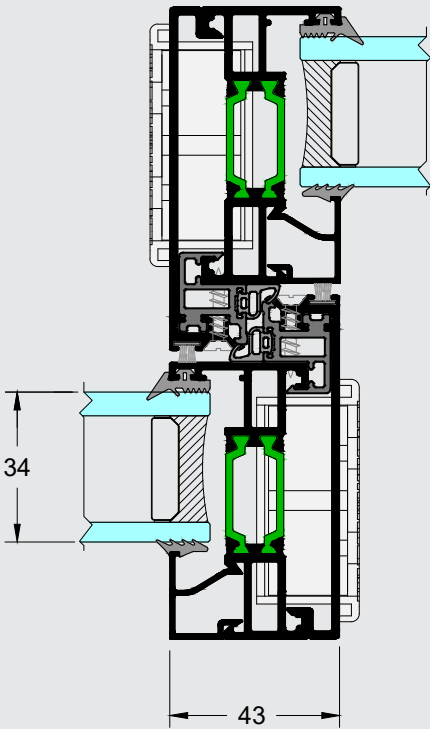

Narrow interlock

QUADRA

Make a design statement
with ALUMINCO handles.

**An aluminium system
is great in the details**



Lift & Slide



Window Handle



Lift & Slide



Door Handle

When you're improving your home, you need to look at the details: those things that you sometimes take for granted, but which often make the difference between a good choice and the best choice. The handle of a window or a door makes its own contribution, adding its own elegance and class. Designed especially for ALUMINCO, our handles look and feel beautiful, function supremely and engineered to last.



Inofita, Viotia GR-32011- Greece
T. +30 22620 47000 ■ F. +30 22620 47090
www.aluminco.com ■ info@aluminco.com